

Ø0.63
12 EQ. PLC'S
ON Ø7.63 B.C.
BOTH FLANGES

Ø7.63
B.C.

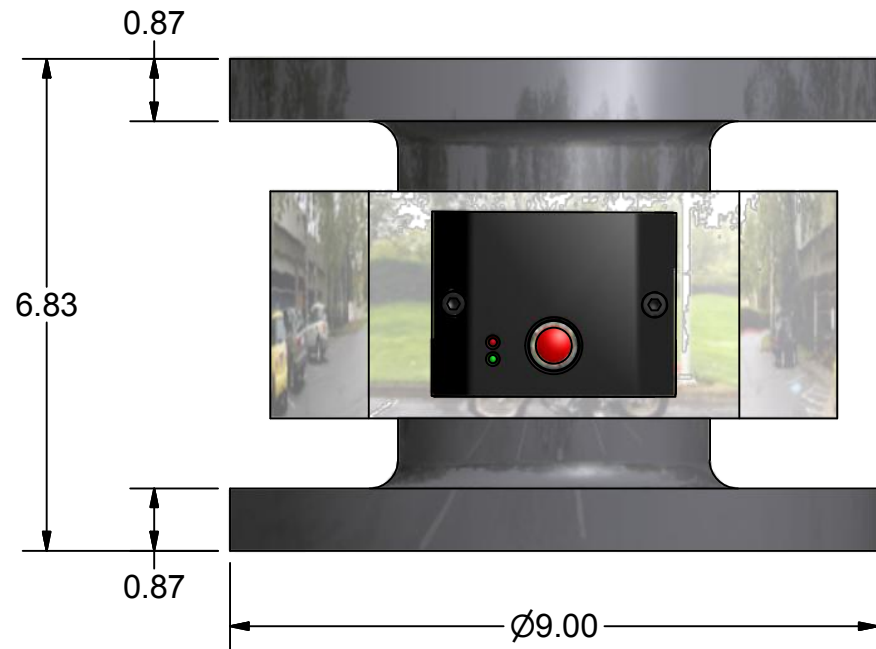
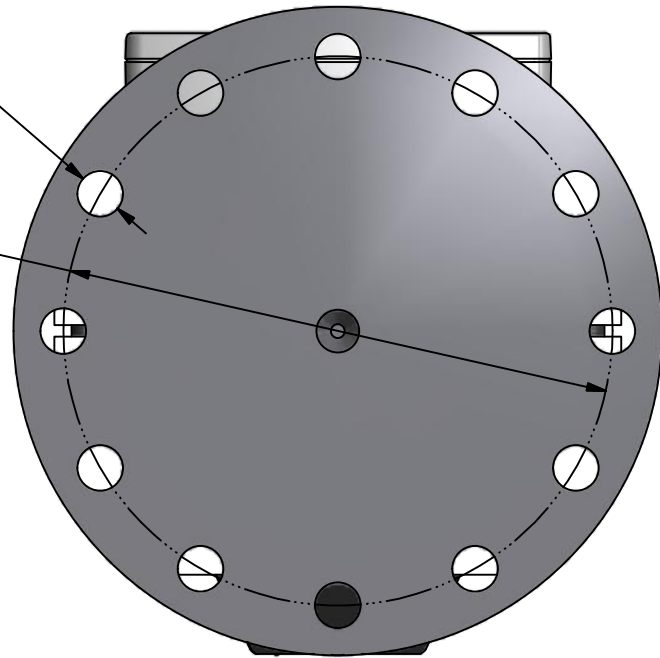

H300-C
0 - 25,000 LBS-FT

Ø0.79
6 EQ. PLC'S
ON Ø7.63 B.C.
BOTH FLANGES

Ø7.63
B.C.

Ø0.79
12 EQ. PLC'S
ON Ø8.63 B.C.
BOTH FLANGES

Ø8.63
B.C.

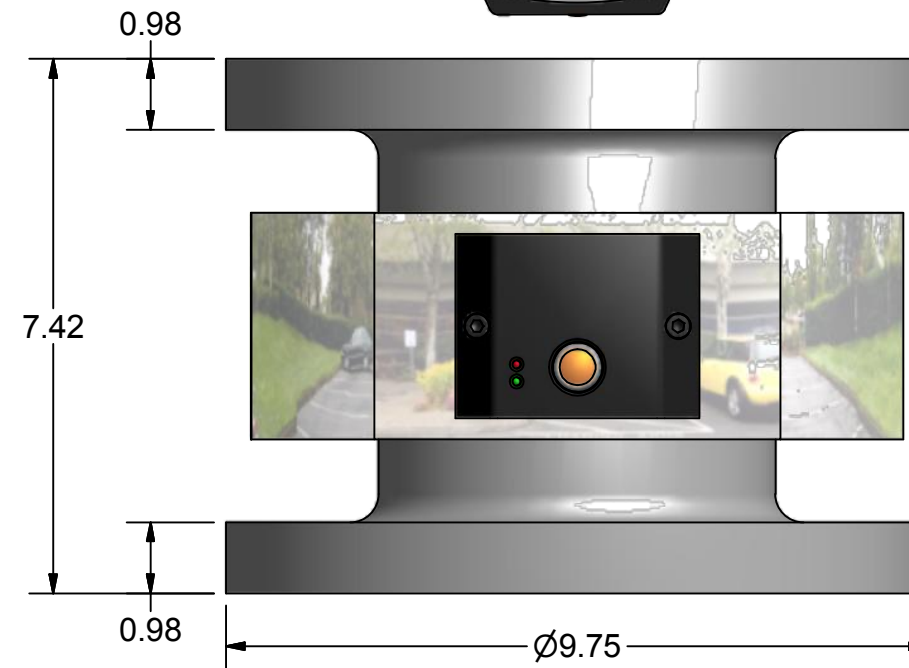
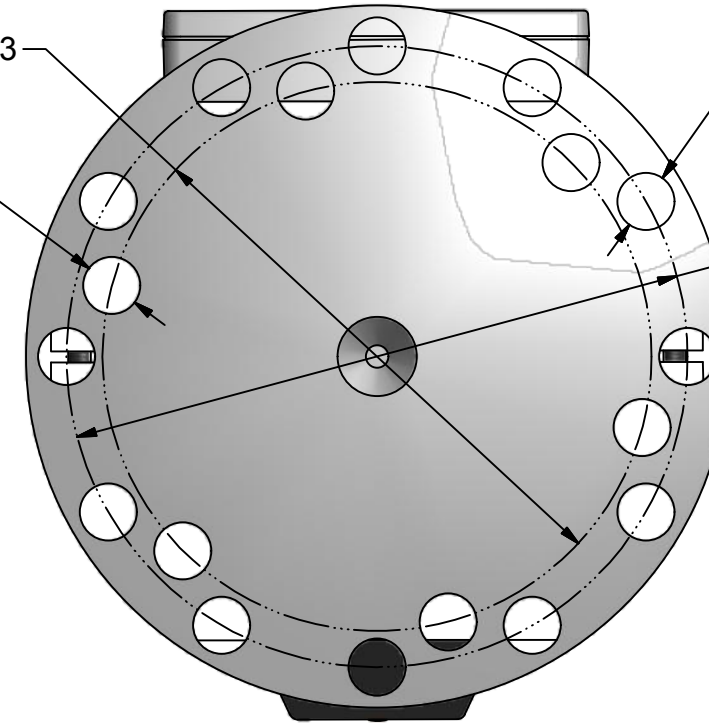

S400-C
0 - 60,000 LBS-FT

MATERIAL	ALL DIMENSIONS ARE IN INCHES TOLERANCES UNLESS NOTED DECIMALS: .XX +/- .06 ; .XXX +/- .010 ANGLES: +/- 1 DEGREE REMOVE ALL BURRS AND SHARP EDGES	DRAWN BY BB	DATE 3/26/2012		PRO-DIG 720 E. 9th STREET LAWRENCE, KS 66044 TEL: 785-856-2661 FAX: 913-562-9914 www.pro-dig-usa.com
FINISH		APPROVED BY BB	DATE		
MODEL		This drawing, including the principles of design, is the property of and is submitted by Pro-Dig, LLC with the understanding that it will not be supplied to others or used in any manner that may constitute a detriment directly or indirectly to Pro-Dig, LLC. Acceptance of this drawing will be construed as an agreement to the above.			
ERN		SCALE	TITLE	SHEET	SHEET
1ST USED			INTELLI-TORK UNITS	1 OF 1	SIZE
WEIGHT					B
NEXT ASSY					PART NUMBER
					H300C and S400C drawing
					REVISION